

BUILT-IN PISTON

with metal and soft wiper, double-acting, pmax. 500 bar

Description:

The built-in piston consists of a piston and a threaded bushing and it includes all seals.

The built-in piston is a subassembly, which has to be integrated directly into the housing body. The housing body has the features of the cylinder housing. The advantage of this design is the minimized space requirement of the clamping or operating cylinders.

The threaded bushing is equipped as standard with a metallic wiper as well as a soft wiper. The hydraulic oil is fed through drilled channels.

Operating conditions:

The built-in piston operates hydraulically double-acting. This enables pulling forces as well as pushing forces to be generated. Use appropriate seals according to the temperature conditions.

The dimensions for manufacturing and the tolerances for surface and dimensions must be complied according to the HYDROKOMP drawings.

After tightening the threaded bushing, it is necessary to secure it by using the supplied threaded pin. For this, a small thread must be fitted into the threaded bore of the bushing into which the threaded pin is screwed.

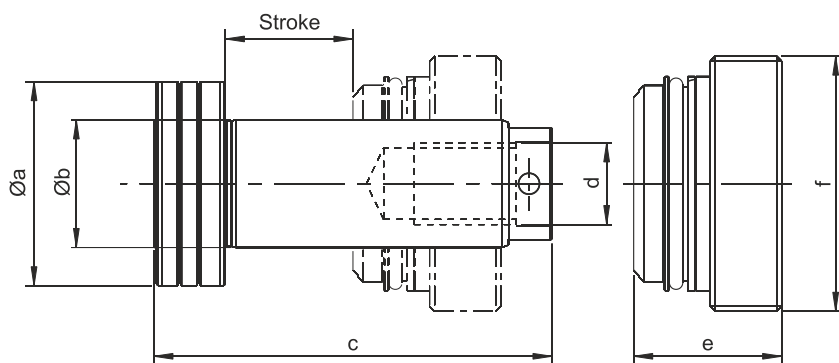

The measurements chart is only for orientation the maximum dimensions. All subassemblies are available as CAD models (2D and 3D) on our website www.hydrokomp.de.

Measurements chart:

Piston					Threaded bushing			
Øa	Øb	c	d	Stroke	Order no. ⁽¹⁾	e	f	Order no. ⁽¹⁾
[mm]	[mm]	[mm]		[mm]				
16	10	56	M6x15	16	EBK-016-016-X	22	M27x1,5	GB-016-X
		72		EBK-016-032-X				
		90		EBK-016-050-X				
20	12	57	M8x16	16	EBK-020-016-X	22	M32x1,5	GB-020-X
		73		EBK-020-032-X				
		91		EBK-020-050-X				
25	16	63	M10x17	20	EBK-025-020-X	22,5	M36x1,5	GB-025-X
		93		EBK-025-050-X				
		143		EBK-025-100-X				
32	20	74	M12x18	25	EBK-032-025-X	27	M42x1,5	GB-032-X
		99		EBK-032-050-X				
		149		EBK-032-100-X				
		209		EBK-032-160-X				
40	25	78	M16x27	25	EBK-040-025-X	29	M50x1,5	GB-040-X
		103		EBK-040-050-X				
		153		EBK-040-100-X				
		213		EBK-040-160-X				
50	32	86	M20x32	25	EBK-050-025-X	35	M62x1,5	GB-050-X
		111		EBK-050-050-X				
		161		EBK-050-100-X				
		221		EBK-050-160-X				
63	40	99	M27x40	30	EBK-063-030-X	35	M72x1,5	GB-063-X
		132		EBK-063-063-X				
		169		EBK-063-100-X				
		233		EBK-063-160-X				
80	50	109	M30x40	32	EBK-080-032-X	43	M95x2	GB-080-X
		157		EBK-080-080-X				
		177		EBK-080-100-X				
		241		EBK-080-160-X				
100	63	119	M42x60	40	EBK-100-040-X	44	M115x2	GB-100-X
		179		EBK-100-100-X				
		243		EBK-100-160-X				

⁽¹⁾Select the correct order number:
Replace X by sealing NBR = 001, FKM = 002.



Webcode: 020004

We also design and manufacture special designs

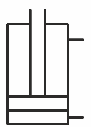

Sealing:

- NBR, Operating temperature: -10° up to +80°C
- FKM, Operating temperature: up to max. 150°C

Power range:

- from 2 kN with piston Ø 16 mm, at 100 bar operating pressure
- from 392 kN with piston Ø 100 mm, at 500 bar operating pressure

Stroke range:

- from 16 mm up to 160 mm special strokes on request

Advantages:

- Space-saving mounting options
- Mounting directly into the housing body
- With metal wiper and soft wiper as standard
- Oil fed through drilled channels



Siemensstraße 16, 35325 Mücke (Germany)
Phone: +49 6401 225999-0
Fax: +49 6401 225999-50
E-mail: info@hydrokomp.de
Internet: www.hydrokomp.de